

A story of constant change:

For nearly 200 years Christ Church has been a place of worship for the growing population of Downend and beyond. It has played a central role in community life - the place where local people have come to be married, buried and baptised. Schools have valued it and succeeding generations have cared for it and regularly redeveloped it as times have changed.

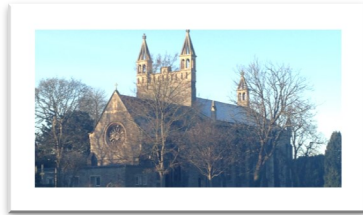

1831: Christ Church built

1875: Original pews replaced

1913: Chancel extended to include a sanctuary & rose window

1931: New vestries for choir and clergy added

1956: Parish Hall built

1985: Pews removed at west end to create reception area

2003: Choir stalls removed and chancel enlarged, outside access improved

2011: Spiritual Garden created

2013: Parish Hall refurbished and Youth Hub built

2017: The story continues

These changes were made because our predecessors were able to recognise the need to adapt the building as new mission opportunities arose. They had the courage to trust God and step out in faith, to give sacrificially and see the work completed.

Our Mission Partners in Moldova



Over the past 5 years our partnership with Pastor Misa and the church in Moldova has resulted in them being able to build the very first church in the village of Ursoaia, thanks to the tithing of monies given so far to our building project. We would like to maintain our support for him and his

ministry in this incredibly poor part of Eastern Europe by continuing to tithe our gifts. Please consider this as you respond in the coming weeks to the invitation to bring to completion the work our Lord has called us to in the service of his kingdom.



What happens next ?

The work will cost in the order of £1 million. This includes a substantial amount of long standing repairs to the fabric of the building such as repointing stonework, renewing the drainage, lighting, heating and sound systems, and rewiring and redecorating the whole church. We are blessed to already have half of that amount thanks to generous giving, legacies and the sale of properties. The remainder of the total cost needs to be either given, pledged or secured in grant funding by September so that the work can begin this autumn.



Giving4Life - turn the vision into reality

This is a once in a life time opportunity - we won't be doing it again!

And if we all play our part we can make it happen.

How?

First of all, pray – asking the question, *'how much of all that God has entrusted me with now does He want me to invest in the future of Christ Church?'*

Then respond by:

- Making a one off gift
- Pledging an amount to be spread over 2 years
- Offering an interest free loan

Please tick one or more of the boxes on the enclosed form and return in the envelope provided. You can also do this via the website www.christchurchdownend.com

There will be some people who have contacts with businesses and organisations who might see this project as an opportunity to invest in their local community. Please do explore possibilities with the support of the Building4Life Fundraising Team. If you have experience in approaching grant-making bodies, it would be great to have your input.

Any Questions?

If you have any questions about the re-ordering project, please contact Maggie Nichols and the Building4Life Team at the following email address:

building4life@christchurchdownend.com

Building4Life

..... a window of opportunity



Photo of Christ Church: Chris Dobson

*Now choose life, so that you
and your children may live!*

Deuteronomy 30:19

It's all about life! God has given us life, and our vision is focused on being a community of all ages which is learning to live that life wherever we are and whatever we do.

So now we are Building4Life. Having explored over many years what changes need to be made for the Parish Church to be a building that is appropriate for life in 21st century, we have prayerfully discerned a vision for Christ Church to become a place for...

- building community
- celebrating creativity and
- deepening Christian spirituality

We have the plans in place and the process clearly marked out. Now is the time for action - to seek the Lord in prayer and to respond to the promptings of His Spirit. We have been entrusted to get Christ Church prepared for the greater things God is going to do in the days ahead across all generations.

What an opportunity this is!

A window into the future



Community

Enriched hospitality

-the kitchen will be twice the current size and there will be a welcome desk by the door. The screen into the nave will slide and can be folded back to allow both spaces to work together. The side balconies will be level and carpeted so that they can be used in all kinds of ways during the weeks as well as Sundays. For example, young children could play safely, or small groups could meet informally.

An environment to lift the spirit

-the Garden Room will have full length windows to let in the light and connect with the Spiritual Garden; the bespoke storage areas will mean that the church will be free from clutter.

Access for all throughout the ground floor

-a new side entrance will be formed and levels lowered so that there are no steps to negotiate and free flowing wheelchair access inside and out.

A hub of life at the heart of the community

- new spaces to meet and build relationships, for community groups to gather and for existing ministries to grow such as CAP (Christians Against Poverty), Open Church, Messy Church and Jigsaw.

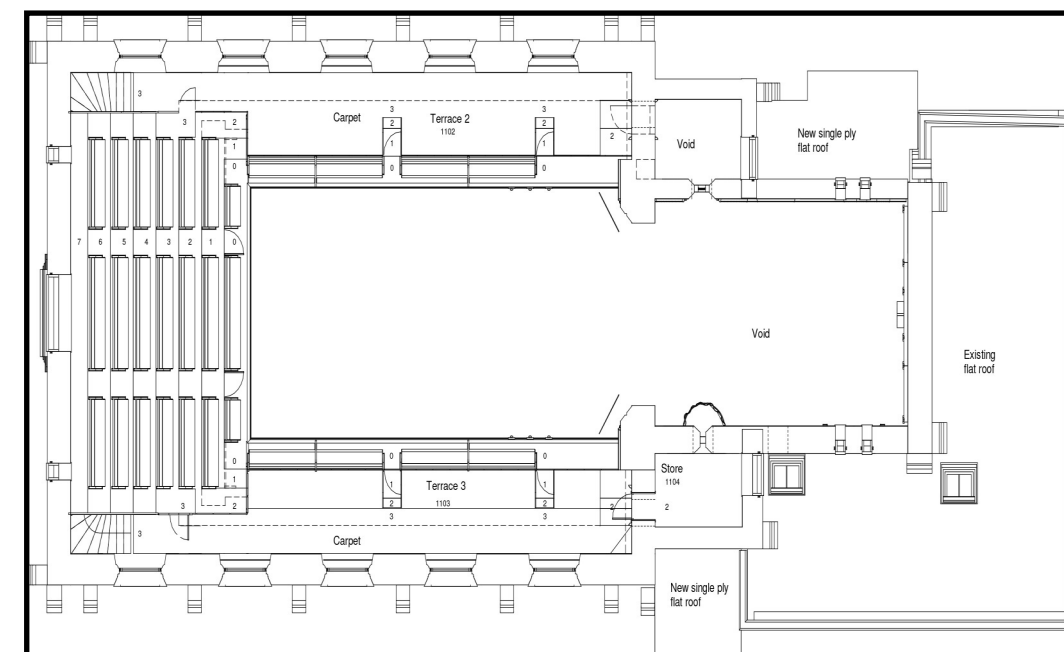

Creativity

An adaptable space

-for worship and the creative arts - high quality chairs will replace the pews, new lighting, sound and vision will be installed, drawing on the latest innovative technology.

Exhibition space

-for local artists and schools - the walls will be redecorated and made suitable for art installations of all kinds.

Architecture

-to reflect the uniqueness of this Georgian building and combine it with imaginative contemporary design.

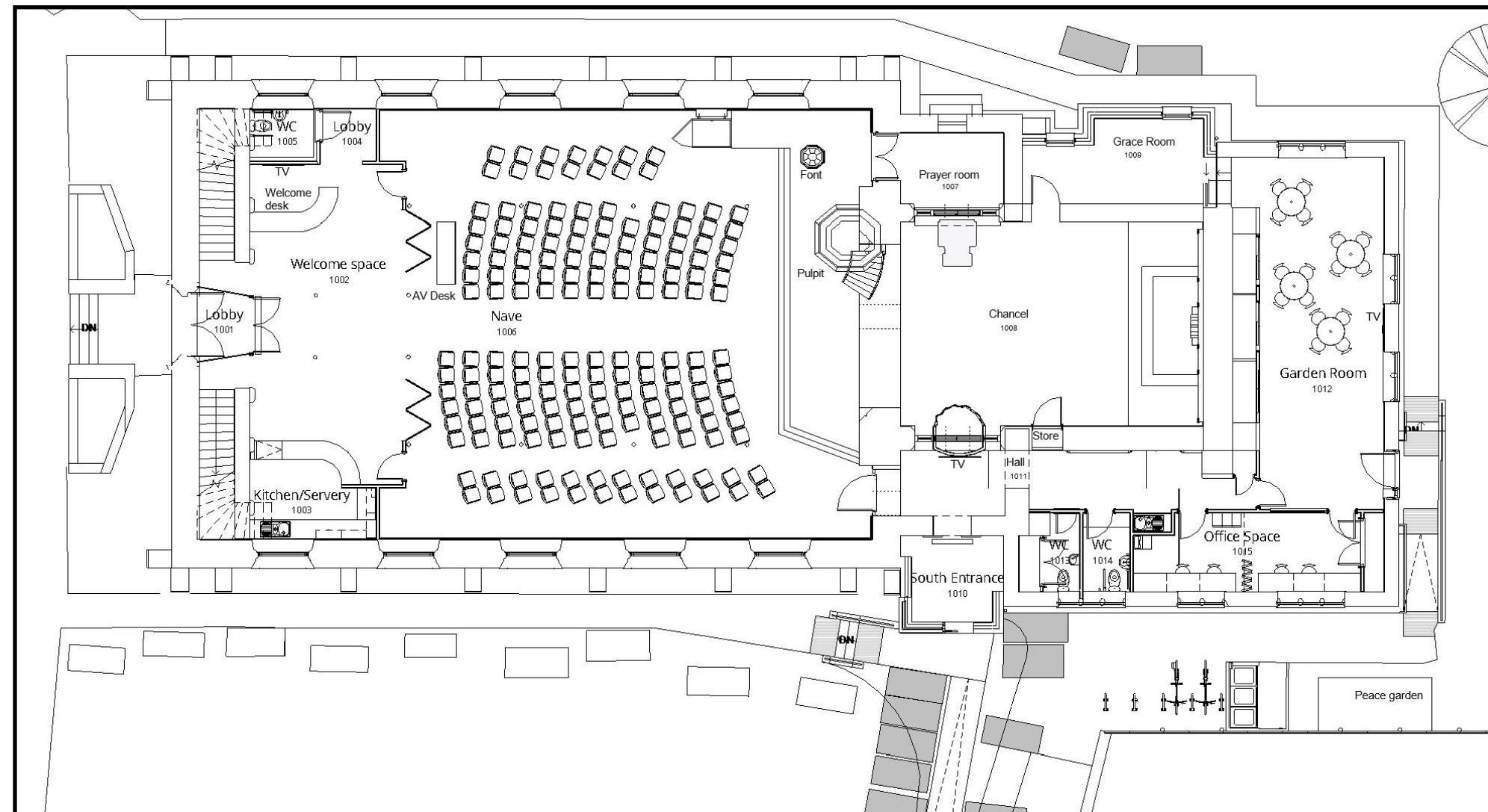

Christian Spirituality

Prayer at the heart of the church

-as a prayer chapel is formed which is simple and sound-proof, offering a place to know God in stillness.

Enriched worship

-as we will have many more options for laying out the main worship area to create space for café church, informal types of services, concerts, drama productions, conferences, 24/7 prayer stations and collective worship for schools.

Respect for the significance of God's creation

-as underfloor heating is laid, draughts excluded, insulation installed and energy loss reduced to a minimum.